

Note that all unique customer requirements (i.e tolerance) need to be verified thru Alfa Laval.

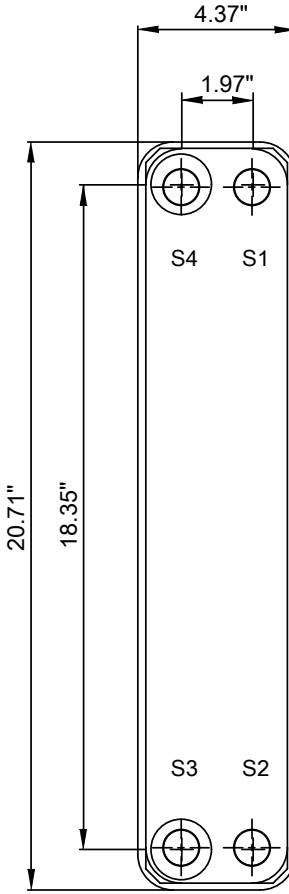
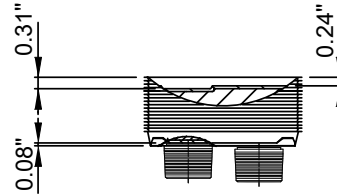
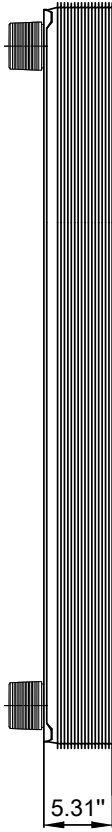
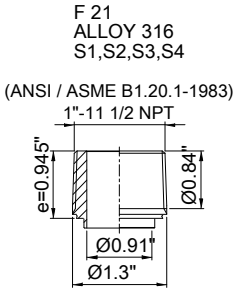

Frameplate is depressed 0.08 inches at connection S3/S4  
 Pressureplate is depressed 0.08 inches / even number of channel plates  
 at connections T3/T4 / uneven number of channel plates at  
 connections T1/T2.

HEATING SURFACE                      ft<sup>2</sup>  
 NETWEIGHT                              28.5 lb  
 OPERATING WEIGHT                    lb  
 PLATE MATERIAL                        ALLOY 316  
 PLATE GROUPING                        1\*24H/1\*25H

T1 T2 T3 T4 locations on back side  
 correspond to S1 S2 S3 S4 on front side

ALL DIMENSIONS IN INCHES

SIDE	MEDIA	INLET	TEMP.	OUTLET	TEMP.	FLOW RATE	PRESSURE DROP	LIQUID VOL.
1	Water	S1	°F	S2	°F	lb/h	psi	0.08 ft <sup>3</sup>
2	Water	S3	°F	S4	°F	lb/h	psi	0.08 ft <sup>3</sup>

PRESSURE VESSEL APPROVAL

PED/CRN



AlfaNova 52-50H (3287000899)

[www.alfalaval.com](http://www.alfalaval.com)

CUSTOMER NAME / REF. NO.

COMPANY / REF.  
 Alfa Laval Nordic AB  
 Alfa Laval Inc.

TOTAL LENGTH                              6.3 in  
 TOTAL WIDTH                                4.4 in  
 TOTAL HEIGHT                               20.7 in



8/25/2021  
 REV 0